



Two bedrooms and two baths

Interior Space: 944 sf

Solarium (Lv3): 94 sf

Solarium (Lv4): 120 sf

Level 3 Patio: 600 sf

Level 4 Patios: 148 sf

Total Living Space: 1,038 sf (Lv3) - 1,064 sf (Lv4)

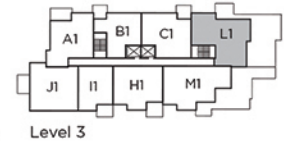
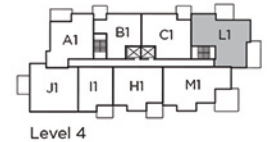

In a continuing effort to make product improvements, the developer reserves the right to modify or change plans, specifications, and features without notice. Floorplans, elevations, room sizes, decks, and square footages are approximate and may slightly vary from the actual built home. Renderings are artist illustrations. Furniture and décor items are shown as example only and are not included. This is not an offering for sale. Any such offer may only be made with a BC Disclosure Statement. E.&O.E.